

THE PURPLE™ STIRRUP REPAIR GUIDE

03-0105-A GAS SPRING REPLACEMENT

Scope: This document provides instructions for the replacement of the Gas Spring on the Kyra Comfort 3000, 3100, 5000, 5100, 5200 and similar models.

BEFORE USING THIS PROCEDURE ENSURE THAT IT IS THE LATEST REVISION:

03-0105, Rev A

Kyra Repair Guide_Gas Spring
ECO 1053, Effective Date: 28 June, 2019

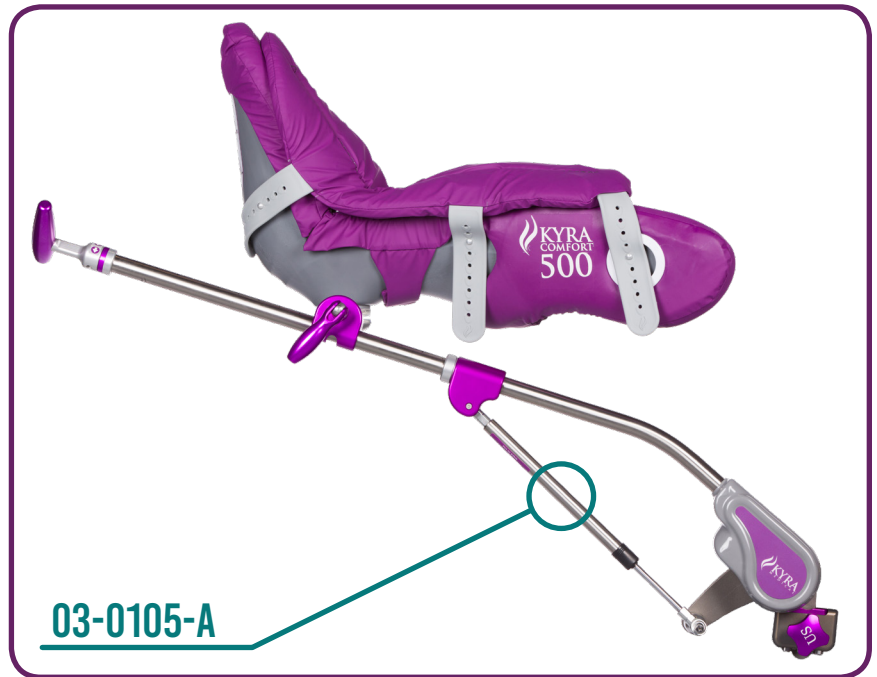

REQUIRED COMPONENTS, OTS PARTS AND MATERIALS

ITEM	PART NUMBER	DESCRIPTION	QTY.
1	CMP-1016-A	SS Gas Spring, 100# with Cover	1
2	OTS-1034	Rod End, M6x1, RH, Fem, 6mmID, 14mmL	2
3	OTS-1047	Loctite 243 Threadlocker, One-time use, .02 oz	1

Property of Kyra Medical, Inc. ©2019



1. REMOVAL INSTRUCTIONS:

1. Mount the stirrup onto a surgical rail or clamp the mount blade into a vice. Extend the Stirrup vertically until the slide mount is completely extended. This will remove all pressure from the Gas Spring. (fig. 1.1.a)



(fig. 1.1.a)

1. REMOVAL INSTRUCTIONS: (CONT'D)

- 2a. Using a 3mm hex wrench, loosen the Gas Spring Mount screw. This fastener is held in with Loctite 243 (blue) so will require a moderate amount of force to break loose. (fig.1.2.a)



- 2b. Remove the Shoulder Screw and all associated hardware from the mount and then fully from the Rod End of the Gas Spring. (fig. 1.2.b)

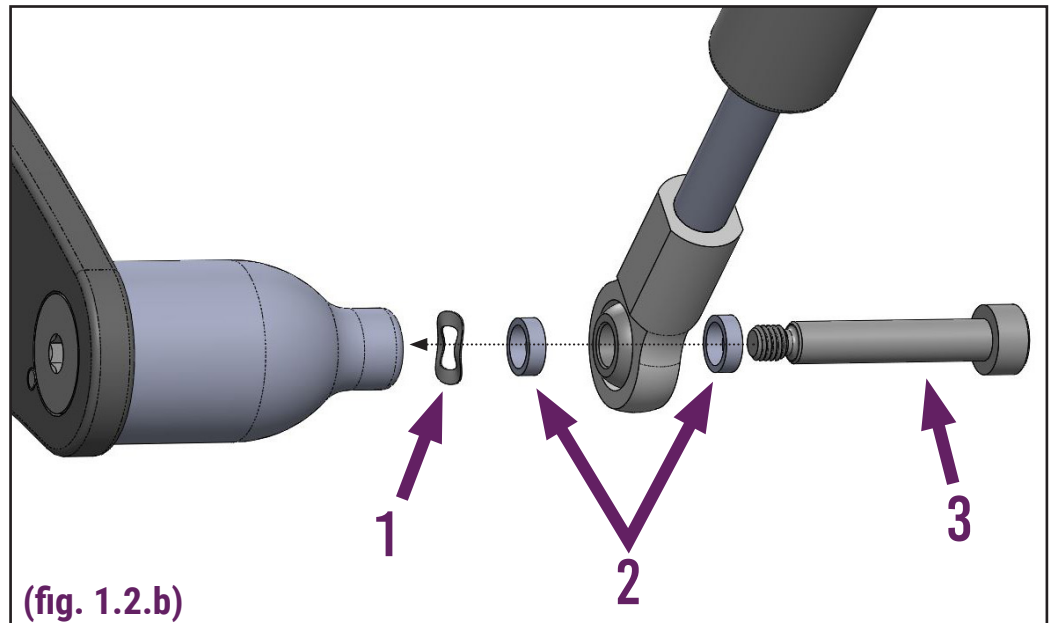

1: OTS-1071
Wave Disc Spring, 0.244" ID,
0.386" OD, 0.008" Thick

2: CMP-1175-A1
Mount Standoff Washer,
0.241" ID, 0.319" OD, 0.098" Thick

3: OTS-1063
18-8 Stainless Steel Precision Shoulder Screw, 6 mm Shoulder Diameter,
30 mm Shoulder Length, M5 x 0.8
mm Thread

1. REMOVAL INSTRUCTIONS: (CONT'D)

- 3a. At the other end of the Gas Spring, on the Slide Mount, position a flat head screwdriver to hold the standoff in place. (fig. 1.3.a)



- 3b. While holding the flat head screwdriver in position, remove the tamper-proof fastener from the opposite side of the Slide Mount with a T15 Security Torx bit. (fig. 1.3.b)



1. REMOVAL INSTRUCTIONS: (CONT'D)

4. Using a pointed tool or the 3mm hex wrench, push the standoff out of the Slide Mount enough to grab and remove it. Leave the 3mm in place to make the next steps easier and to prevent the parts from falling to the floor. (fig. 1.4.a)



5. Place a hand under the Slide Mount. Slowly remove the pointed tool or 3mm wrench from the Slide Mount. The first white bearing will fall out, then the Gas Spring is free to remove, then the second white bearing. Disassembly is complete. (fig. 1.5.a)



2. ASSEMBLY INSTRUCTIONS:

1. Install the Flathead Standoff into the Slide Mount enough to place one white bearing onto it. (fig. 2.1.a)



2. Push the Standoff further in and hang the Gas Spring from it. **BE SURE THAT THE LARGER, HOUSING SIDE OF THE GAS SPRING IS AT THE TOP AND THE THINNER PISTON SIDE IS AT THE BOTTOM** (fig. 2.2.a)



2. ASSEMBLY INSTRUCTIONS: (CONT'D)

3. Push the Standoff a small amount further and install the Second White Bearing on the other side of the Gas Spring. (fig. 2.3.a)

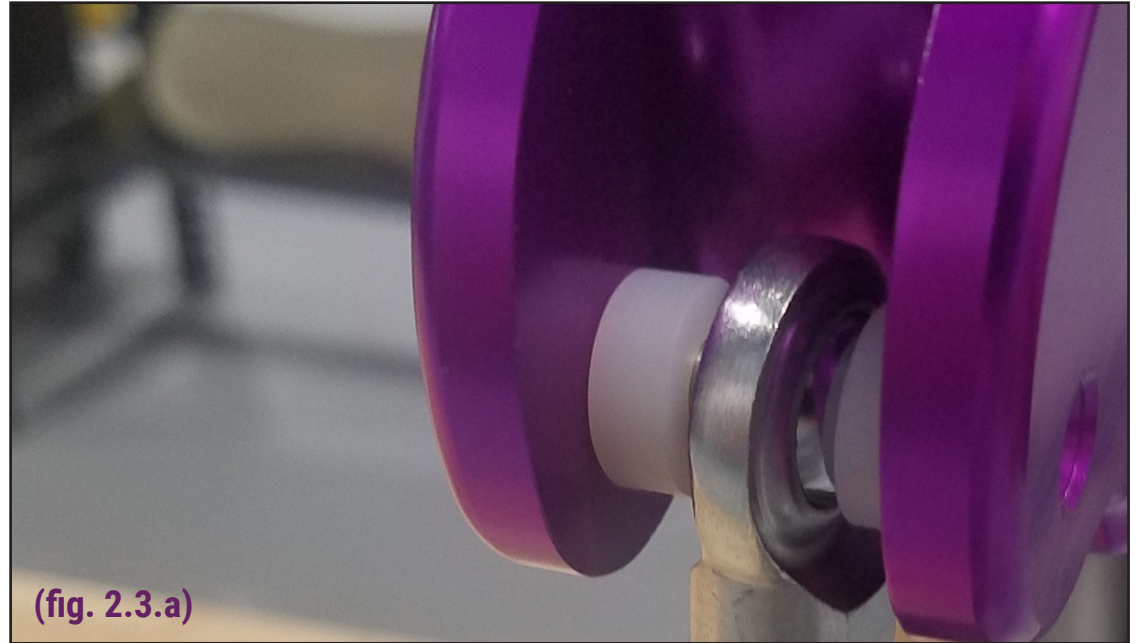

4. Apply a small amount of Loctite 243 (Blue) to the Flat Head Security Torx fastener and thread hand tight. Place the flathead screwdriver on the standoff as in the removal step and tighten. (fig. 2.4.a)



2. ASSEMBLY INSTRUCTIONS: (CONT'D)

5. With the Stirrup mounted in a surgical rail and positioned in a vertical position. Assembly order pictured below, (fig. 2.5.a). Apply Loctite 243 (Blue) to OTS-1063, Shoulder Screw. Use a 3mm Hex wrench to tighten all components.

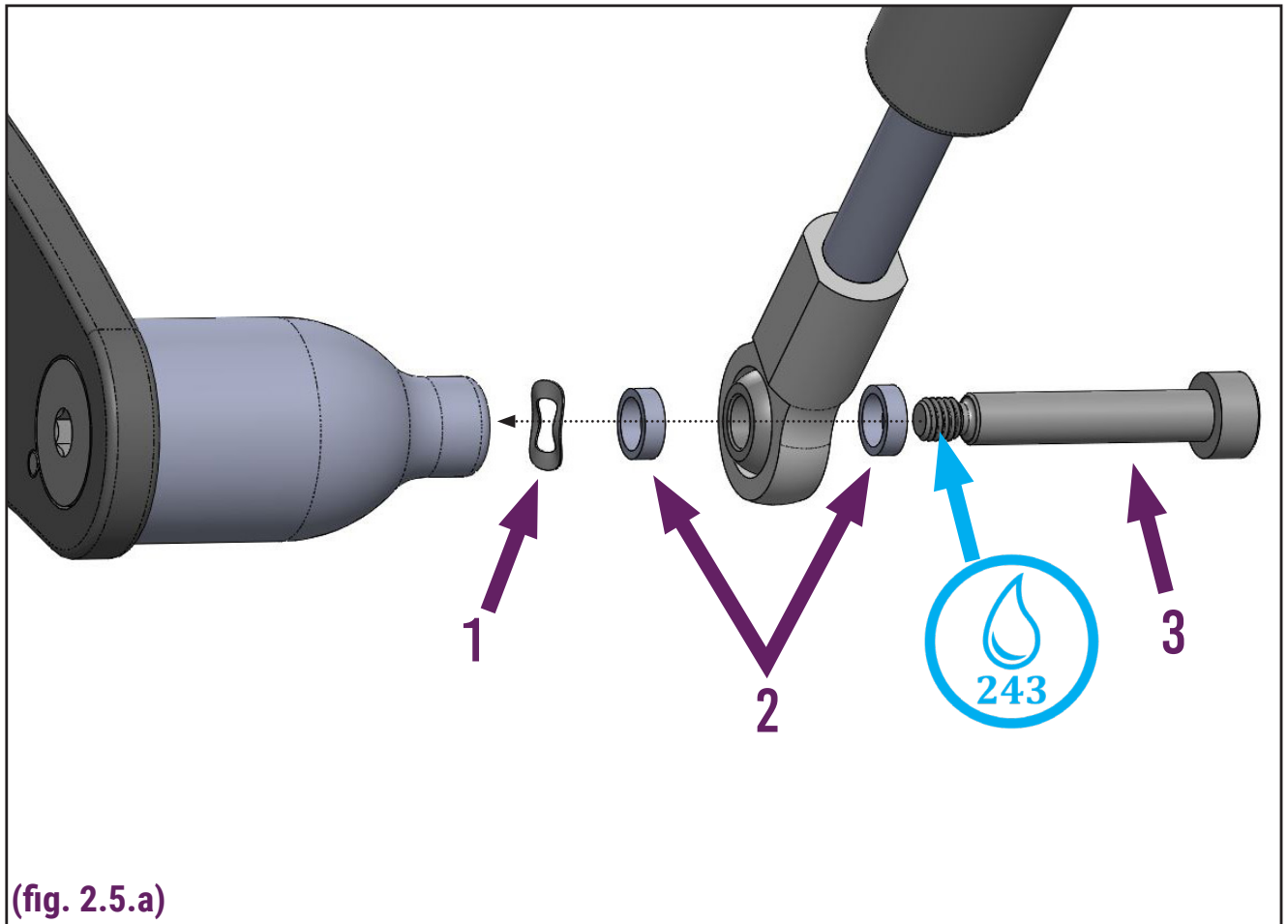

(fig. 2.5.a)

- 1:** OTS-1071
Wave Disc Spring, 0.244" ID,
0.386" OD, 0.008" Thick
- 2:** CMP-1175-A1
Mount Standoff Washer,
0.241" ID, 0.319" OD, 0.098" Thick

- 3:** OTS-1063
18-8 Stainless Steel Precision Shoulder Screw, 6 mm Shoulder Diameter,
30 mm Shoulder Length, M5 x 0.8 mm Thread



Threadlocker, Loctite® 243 -or equivalent

3. Test Range of Motion and Functionality of the Stirrup.

END