

PHYSICAL SPECIFICATIONS		SPECIFICATION	
DESCRIPTION		PARABOLA Y2-5X	
REFLECTOR GEOMETRY		1.00 (25.40)	
WINDOW DIAMETER			
OPERATIONAL SPECIFICATIONS			
DESCRIPTION	NOMINAL	RANGE	
POWER (WATTS)	300	180-330	
CURRENT (AMPS DC)	21	13-24	
VOLTAGE (VOLTS DC)	14	12-15.5	
IGNITION VOLTAGE	25 KILOVOLTS (MINIMUM RECOMMENDED)		
LAMP TEMPERATURE	150 C MAXIMUM AT 300 WATTS		

DRAWING SUBJECT TO CHANGE WITH NOTIFICATION.

REVISIONS				
ZONE	REV	DESCRIPTION	DATE	APPROVED
-	A	INITIAL RELEASE	09/19/13	PLB

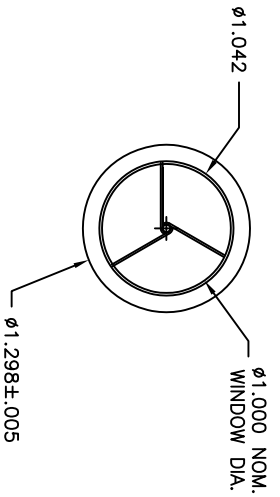
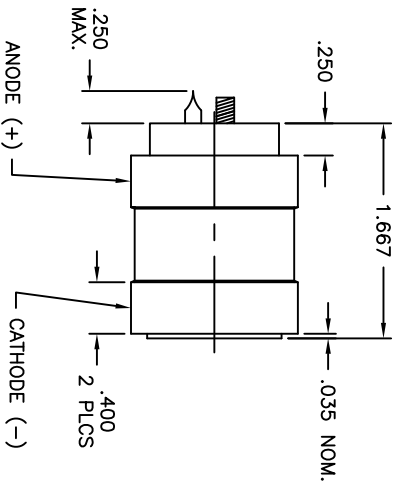
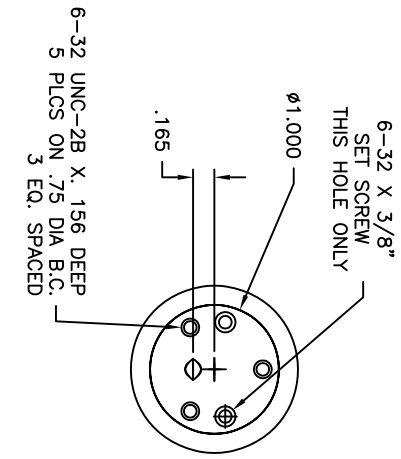

- NOTES:
1. NOMINAL OPERATING PARAMETERS:
CURRENT - 21 AMPS
VOLTAGE - 14 VOLTS
 2. 6-32 X 3/8" SET SCREW IN HOLE AS SHOWN.
 3. DIRECT REPLACEMENT FOR OLYMPUS MAJ-1817 LAMP.

UNLESS OTHERWISE SPECIFIED: DIMENSIONS ARE IN INCHES. TOLERANCES ARE: .XXX ± .005 .XX ± .01 FRACTIONS ± 1/64 ANGLES ± 1°			
PROPERTY, REPRODUCTION, USE OR DISCLOSURE TO THIRD PARTIES WITHOUT EXPRESS AUTHORITY IS STRICTLY PROHIBITED.			
TITLE		LUXTEL	
CL1854,		OLYMPUS MAJ-1817	
SIZE	FSQM NO.	DWG NO.	REV
B		1854	A
SCALE 1:1	DO NOT SCALE DRAWING	SHEET 1 OF 1	